

d: 15.875 ~ 25.000 mm

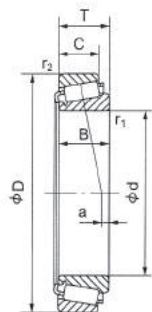

Principal Dimensions (mm)							Bearing Designations		Basic Load Ratings (N)		Limiting Speed (rpm)	
d	D	T	B	C	r <sub>1</sub> (min)	r <sub>2</sub> (min)	Cone	Cup	Dynamic Cr	Static Cor	Grease	Oil
15.875	34.988	10.998	10.998	8.712	1.3	1.3	<b>L21549</b>	<b>L21511</b>	13800	13400	11000	15000
	42.862	14.288	14.288	9.525	1.5	1.5	<b>L1590</b>	<b>11520</b>	17800	17800	8500	12000
16.993	39.992	12.014	11.153	9.525	0.8	1.3	<b>A6067</b>	<b>A6157</b>	14900	15700	10000	14000
17.462	39.878	13.843	14.605	10.668	1.3	1.3	<b>LM11749</b>	<b>LM11710</b>	23400	23000	10000	13000
17.463	39.878	13.843	14.605	10.668	1.2	1.2	<b>LM11749R</b>	<b>LM11710</b>	25400	25000	8800	12000
19.050	39.992	12.014	11.153	9.525	1.0	1.3	<b>A6075</b>	<b>A6157</b>	14900	15700	10000	14000
	45.237	15.494	16.637	12.065	1.3	1.3	<b>LM11949</b>	<b>LM11910</b>	29900	30500	9000	12000
	47.000	14.381	14.381	11.112	1.3	1.3	<b>05075</b>	<b>05185</b>	24900	25400	8500	11000
	49.225	18.034	19.050	14.288	1.3	1.3	<b>09067</b>	<b>09195</b>	37500	37500	8500	11000
	49.255	210.209	19.050	17.463	1.3	1.5	<b>09067</b>	<b>09196</b>	37500	37500	8500	11000
	49.225	21.209	19.050	17.463	1.3	3.5	<b>09067</b>	<b>09194</b>	37500	37500	8500	11000
	49.225	19.845	21.539	14.288	1.3	1.3	<b>09078</b>	<b>09195</b>	37500	37500	8500	11000
	49.225	23.020	21.539	17.463	1.3	1.5	<b>09078</b>	<b>09196</b>	37500	37500	8500	11000
	49.255	23.020	21.539	17.463	1.3	3.5	<b>09078</b>	<b>09194</b>	37500	37500	8500	11000
	49.225	19.845	21.539	14.288	1.3	1.3	<b>09074</b>	<b>09195</b>	37500	37500	8500	11000
	49.225	23.020	21.539	17.463	1.3	1.5	<b>09074</b>	<b>09196</b>	37500	37500	8500	11000
	49.225	23.020	21.539	17.463	1.3	3.5	<b>09074</b>	<b>09194</b>	37500	37500	8500	11000
19.987	47.000	14.381	14.381	11.112	1.5	1.3	<b>05079</b>	<b>05185</b>	24900	25400	8500	11000
20.638	49.225	19.845	19.845	15.875	1.5	1.5	<b>12580</b>	<b>12520</b>	36000	37000	8000	11000
21.430	50.005	17.526	18.288	13.970	1.3	1.3	<b>M12649</b>	<b>M12610</b>	37000	37500	8000	11000
21.987	45.237	15.494	16.637	12.065	1.27	1.27	<b>LM12749</b>	<b>LM12710</b>	30100	34600	7400	10000
	45.975	15.494	16.637	12.065	1.27	1.27	<b>LM12749</b>	<b>LM12711</b>	30100	34600	7400	10000
22.225	50.005	13.495	14.260	9.525	1.3	1.0	<b>07087</b>	<b>07196</b>	26000	27700	7500	10000
	50.005	17.526	18.288	13.970	1.3	1.3	<b>M12618</b>	<b>M12610</b>	37000	37500	8000	11000
	52.388	15.011	14.260	12.700	1.3	1.3	<b>07067</b>	<b>07204</b>	26000	27700	7500	10000
	52.388	19.368	20.168	14.288	1.5	1.5	<b>1380</b>	<b>1328</b>	42500	47500	7500	10000
	53.975	19.368	20.168	14.288	1.5	1.5	<b>1329</b>	<b>1329</b>	36700	37900	6700	9400
	57.150	22.225	22.225	17.463	0.8	1.6	<b>1280</b>	<b>1220</b>	52600	55700	6300	8900
23.812	56.896	19.368	19.837	15.875	0.8	1.3	<b>1779</b>	<b>1729</b>	40500	44000	7100	9500
24.981	50.005	13.495	14.260	9.525	1.5	1.0	<b>07098</b>	<b>07196</b>	26000	27700	7500	10000
	51.994	15.011	14.260	12.700	1.5	1.3	<b>07098</b>	<b>07204</b>	26000	27700	7500	10000
25.000	50.005	13.495	14.260	9.525	1.5	1.0	<b>07097</b>	<b>07196</b>	26000	27700	7500	10000
	51.994	15.011	14.260	12.700	1.5	1.3	<b>07097</b>	<b>07204</b>	26000	27700	7500	10000

Note : when load center is (-), and it is out of inner ring plane

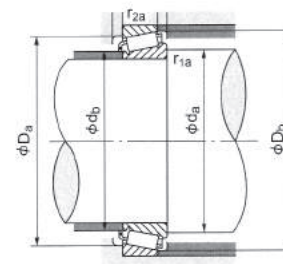

Abutment and Fillet Dimensions (mm)							Eff. Load Centers (mm) a	Weight (kg)	
d <sub>a</sub> (min)	d <sub>b</sub> (min)	D <sub>a</sub> (max)	D <sub>b</sub> (max)	r <sub>1a</sub> (max)	r <sub>2a</sub> (max)			Cone	Cup
21.5	19.5	29.0	32.5	1.3	1.3	3.3	0.033	0.019	
24.5	22.5	34.5	39.5	1.5	1.5	1.1	0.060	0.040	
22.0	21.0	34.0	37.0	0.8	1.3	1.5	0.040	0.032	
23.0	21.5	34.0	37.0	1.3	1.3	5.2	0.055	0.026	
23.0	21.5	34.0	37.0	1.2	1.2	5.1	0.058	0.028	
24.0	23.0	34.0	37.0	1.0	1.3	1.5	0.037	0.032	
25.0	23.5	39.5	41.5	1.3	1.3	5.6	0.080	0.045	
25.0	23.5	40.5	42.5	1.3	1.3	3.9	0.074	0.046	
25.5	24.0	42.0	44.5	1.3	1.3	9.1	0.110	0.065	
25.5	24.0	41.5	44.5	1.3	1.5	7.3	0.110	0.085	
25.5	24.0	41.5	44.5	1.3	3.5	7.3	0.110	0.081	
25.5	24.0	42.0	44.5	1.3	1.3	9.1	0.110	0.065	
25.5	24.0	41.5	44.5	1.3	1.5	7.3	0.110	0.085	
25.5	24.0	41.5	44.5	1.3	3.5	7.3	0.110	0.081	
25.5	24.0	42.0	44.5	1.3	1.3	9.1	0.110	0.065	
25.5	24.0	41.5	44.5	1.3	1.5	7.3	0.110	0.085	
25.5	24.0	41.5	44.5	1.3	3.5	7.3	0.110	0.081	
26.5	24.0	40.5	42.5	1.5	1.3	3.9	0.070	0.046	
28.5	26.0	42.5	45.5	1.5	1.5	7.1	0.115	0.066	
27.5	25.5	44.0	46.0	1.3	1.3	6.4	0.110	0.059	
27.5	26.0	40.0	42.5	1.2	1.2	5.5	0.073	0.038	
27.5	26.0	40.0	42.5	1.2	1.2	5.5	0.078	0.043	
28.5	27.0	44.5	47.0	1.3	1.0	2.9	0.095	0.035	
28.5	26.5	44.0	46.0	1.3	1.3	6.4	0.107	0.059	
28.5	27.0	44.5	47.0	1.3	1.3	4.4	0.094	0.060	
29.5	27.0	45.0	48.5	1.5	1.5	7.6	0.130	0.067	
29.5	27	46	49	1.5	1.5	7.6	0.131	0.068	
29.5	29.0	49.0	52.0	0.8	1.6	7.9	0.188	0.107	
29.5	28.5	49.0	51.0	0.8	1.3	6.8	0.143	0.100	
31.0	29.0	44.5	47.0	1.5	1.0	2.9	0.085	0.035	
31.0	29.0	45.0	48.0	1.5	1.3	2.9	0.085	0.060	
31.0	29.0	44.5	47.0	1.5	1.0	2.9	0.096	0.035	
31.0	29.0	45.0	48.0	1.5	1.3	2.9	0.096	0.060	



d: 25.400 ~ 30.213 mm

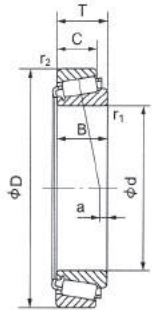

Principal Dimensions (mm)							Bearing Designations		Basic Load Ratings (N)		Limiting Speed (rpm)	
d	D	T	B	C	r <sub>1</sub> (min)	r <sub>2</sub> (min)	Cone	Cup	Dynamic Cr	Static Cor	Grease	Oil
25.400	50.005	13.495	14.260	9.525	1.0	1.0	07100	07196	26000	27700	7500	10000
	50.292	14.224	14.732	10.668	1.2	1.2	L44643R	L44610	31200	37000	6500	9100
	50.292	14.224	14.732	10.668	1.3	1.3	L44643	L44610	28500	34000	7300	10000
	51.994	15.011	14.260	12.700	1.0	1.3	07100	07204	26000	27700	7500	10000
	62.000	19.050	20.638	14.288	0.8	1.3	15101	15245	45000	54500	6000	8000
	62.000	19.050	20.638	14.288	3.5	1.3	15100	15245	45000	54500	6000	8000
	63.500	20.638	20.638	15.875	0.8	1.3	15101	15250	45000	54500	6000	8000
	63.500	19.050	20.638	15.875	3.5	1.3	15100	15250	45000	54500	6000	8000
26.988	65.088	22.225	21.463	15.875	1.5	1.5	23100	23256	43000	45000	5600	8000
	50.292	14.224	14.732	10.668	3.5	1.3	44649	44610	28500	34000	7300	10000
	51.150	17.462	17.462	13.495	3.5	1.5	15580	15520	42500	49000	6700	9000
28.575	62.000	19.050	20.638	14.288	0.8	1.3	45106	15245	45000	54500	6000	8000
	57.150	19.845	19.355	15.875	3.6	1.6	1988R	1922	48800	57100	5800	8200
	68.263	22.225	22.225	17.463	0.8	1.6	02474	02420	51000	61100	5000	7000
29.987	73.025	22.225	22.225	17.462	0.8	3.3	02872	02820	55000	65500	5200	7000
	62.000	16.002	16.566	14.288	1.5	1.5	17118	17244	35000	36000	6300	8500
	62.000	19.050	20.638	14.288	1.3	1.3	15117	15245	45000	54500	6000	8000
30.162	63.500	20.638	20.638	15.875	1.3	1.3	15117	15250	45000	54500	6000	8000
	72.085	22.385	19.205	18.415	0.8	2.4	14118	14283	46100	55000	4900	6900
30.163	64.292	21.433	21.433	16.670	1.5	1.5	M86649	M86610	55000	72500	6000	8000
30.213	64.292	21.433	21.433	16.670	1.57	1.57	M86649R	M86610	55200	70700	5300	7500
	62.000	19.050	20.638	14.288	0.8	1.3	15120	15245	45000	54500	6000	8000
	62.000	19.050	20.638	14.288	3.5	1.3	15118	15245	45000	54500	6000	8000
	63.500	20.638	20.638	15.875	0.8	1.3	12120	15250	45000	54500	6000	8000
	63.500	20.638	20.638	15.875	3.5	1.3	15118	15250	45000	54500	6000	8000

Note : when load center is (-), and it is out of inner ring plane

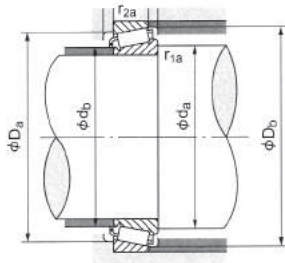

Abutment and Fillet Dimensions (mm)							Eff. Load Centers (mm) a	Weight (kg)	
d <sub>a</sub> (min)	d <sub>b</sub> (min)	D <sub>a</sub> (max)	D <sub>b</sub> (max)	r <sub>1a</sub> (max)	r <sub>2a</sub> (max)			Cone	Cup
30.5	29.5	44.5	47.0	1.0	1.0	2.9		0.080	0.035
31.5	29.5	44.5	47.0	1.2	1.2	3.2		0.092	0.040
31.5	29.5	44.5	47.0	1.3	1.3	3.3		0.085	0.038
30.5	44.5	45.0	48.0	1.0	1.3	4.4		0.080	0.060
32.5	31.5	55.0	58.0	0.8	1.3	5.8		0.215	0.080
38.0	31.5	55.0	58.0	3.5	1.3	4.3		0.215	0.080
32.5	31.5	56.0	58.0	0.8	1.3	7.4		0.215	0.114
38.0	31.5	56.0	58.0	3.5	1.3	4.3		0.215	0.114
39.0	34.6	53.0	61.0	1.5	1.5	2.2		0.210	0.143
37.5	31.0	44.5	47.0	3.5	1.3	3.3		0.080	0.038
38.5	32.0	51.0	53.0	3.5	1.5	2.8		0.135	0.070
33.5	33.0	55.0	58.0	0.8	1.3	5.8		0.205	0.080
39.5	33.5	51.0	53.5	3.6	1.6	5.9		0.151	0.077
36.5	36.0	59.0	63.0	0.8	1.6	5.1		0.251	0.153
37.5	37.0	62.0	68.0	0.8	3.3	3.8		0.313	0.158
37.0	35.0	54.0	57.0	1.5	1.5	3.5		0.137	0.090
36.5	35.0	55.0	58.0	1.3	1.3	5.8		0.180	0.080
36.5	35.0	56.0	59.0	1.3	1.3	5.8		0.180	0.114
52.0	43.0	54.0	62.0	0.8	2.4	4.4		0.238	0.198
41.0	38.2	54.0	61.0	1.5	1.5	3.3		0.210	0.125
41.0	38.0	54.0	61.0	1.6	1.6	3.4		0.213	0.128
36.0	35.5	55.0	58.0	0.8	1.3	5.8		0.183	0.080
41.5	35.5	55.0	58.0	3.5	1.3	5.8		0.178	0.080
36.0	35.0	56.0	58.0	0.8	1.3	7.4		0.183	0.114
41.5	35.5	56.0	58.0	3.5	1.3	7.4		0.178	0.114

d: 31.750 ~ 36.512 mm

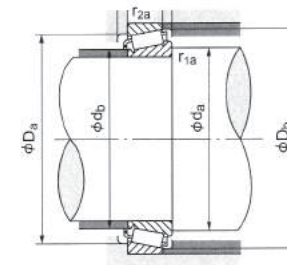
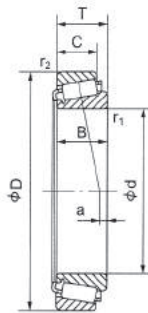

Principal Dimensions (mm)							Bearing Designations		Basic Load Ratings (N)		Limiting Speed (rpm)				Abutment and Fillet Dimensions (mm)						Eff. Load Centers (mm) a	Weight (kg)	
d	D	T	B	C	r <sub>1</sub> (min)	r <sub>2</sub> (min)	Cone	Cup	Dynamic Cr	Static Cor	Grease	Oil			d <sub>a</sub> (min)	d <sub>b</sub> (min)	D <sub>a</sub> (max)	D <sub>b</sub> (max)	r <sub>1a</sub> (max)	r <sub>2a</sub> (max)		Cone	Cup
31.750	59.131	15.875	16.764	11.811	1.3	1.3	LM67048	LM67010	36500	435000	6000	8500			42.5	36.0	52.0	56.0	3.5	1.3	2.9	0.120	0.062
	62.000	18.161	19.050	14.288	1.3	1.3	15123	43500	43500	51500	6000	8000			42.5	36.5	55.0	58.0	3.5	1.3	5.0	0.155	0.080
	62.000	19.050	20.638	14.288	0.8	1.3	12126	15245	45000	54500	6000	8000			37.0	36.5	55.0	58.0	0.8	1.3	5.8	0.167	0.080
	62.000	19.050	20.638	14.288	3.5	1.3	15125	15245	45000	54500	6000	8000			42.5	36.5	55.0	58.0	3.5	1.3	5.8	0.165	0.080
	63.500	20.638	19.050	15.875	1.3	1.3	15123	15250	45000	54500	6000	8000			42.5	36.5	56.0	59.0	3.5	1.3	7.4	0.155	0.114
	63.500	20.638	20.638	15.875	0.8	1.3	15126	15250	45000	54500	6000	8000			37.0	36.5	56.0	59.0	0.8	1.3	7.3	0.167	0.114
	63.500	20.638	20.638	15.875	0.8	1.5	15126	15250	45000	54500	6000	8000			37.0	36.5	55.0	59.0	0.8	1.5	7.3	0.167	0.114
	63.500	20.638	20.638	15.875	3.5	1.3	15125	15250	45000	54500	6000	8000			42.5	36.5	56.0	59.0	3.5	1.3	7.3	0.165	0.114
	63.500	20.638	20.638	15.875	3.5	1.5	15125	15250	45000	54500	6000	8000			42.5	36.5	55.0	59.0	3.5	1.5	7.3	0.165	0.114
	66.421	25.400	25.357	20.638	0.8	3.2	2580	2520	71400	85100	5000	7000			38.5	37.5	57.0	62.8	0.8	3.2	9.4	0.279	0.128
	68.263	22.225	22.225	17.463	3.6	1.6	02475	02420	51000	61100	5000	7000			44.5	38.5	59.0	63.0	3.6	1.6	5.1	0.223	0.153
	69.012	19.845	19.583	15.875	3.5	1.3	14125A	14276	44500	55000	5500	7500			44.0	37.5	60.0	63.0	3.5	1.3	4.3	0.220	0.135
69.012	19.845	19.583	15.875	3.5	3.3	14125A	14274	44500	55000	5500	7500			44.0	37.5	59.0	63.0	3.5	3.3	4.3	0.220	0.130	
69.850	23.812	25.357	19.050	0.8	1.3	2580	2523	70000	84000	5600	7500			38.5	37.5	61.0	64.0	0.8	1.3	8.6	0.290	0.165	
33.338	68.262	22.225	22.225	17.462	0.8	1.5	M88048	M88010	56500	71500	5600	7500			42.5	41.2	58.0	65.0	0.8	1.5	2.8	0.230	0.090
	69.012	19.845	19.583	15.875	0.8	1.2	14131	14276	46100	55000	4900	6900			52.0	13.0	60.0	63.0	0.8	1.2	4.4	0.201	0.136
	69.012	19.845	19.583	15.875	3.5	1.3	14130	14276	44500	55000	5500	7500			45.0	38.5	60.0	63.0	3.5	1.3	4.3	0.210	0.135
	69.012	19.845	19.583	15.875	3.5	3.3	14130	14276	44500	55000	5500	7500			45.0	38.0	59.0	63.0	3.5	3.3	4.3	0.210	0.130
34.925	65.088	18.034	18.288	13.970	1.3	1.3	LM48548	LM48510	48500	59000	5600	7500			46.0	40.0	58.0	61.0	3.5	1.3	3.7	0.160	0.085
	69.012	19.845	19.583	15.875	1.5	1.3	14137A	14276	44500	55000	5500	7500			42.0	40.0	60.0	63.0	1.5	1.3	4.3	0.160	0.135
	69.012	19.845	19.583	15.875	1.5	3.3	14137A	14274	44500	55000	5500	7500			42.0	40.0	59.0	63.0	1.5	3.3	4.3	0.190	0.130
	69.012	19.845	19.583	15.875	3.5	1.3	14138A	14276	44500	55000	5500	7500			46.0	40.0	60.0	63.0	3.5	1.3	4.3	0.189	0.135
	69.012	19.845	19.583	15.875	3.5	3.3	14138A	14274	44500	55000	5500	7500			46.0	40.0	59.0	63.0	3.5	3.3	4.3	0.189	0.130
	69.012	19.845	19.583	15.875	3.6	1.2	14138A	14276	46100	55000	4900	6900			52.0	43.0	60.0	63.0	3.6	1.2	4.4	0.185	0.136
	72.233	25.400	25.400	19.842	2.4	2.4	HM88649	HM88610	66900	87400	4700	6600			48.5	42.5	60.0	69.0	2.4	2.4	4.7	0.305	0.189
	73.025	23.812	24.608	19.050	1.5	0.8	25877	25821	73000	88500	5200	7100			47.0	40.5	64.0	68.0	1.5	0.8	8.1	0.310	0.165
	73.025	23.813	24.608	19.050	1.6	0.8	25877R	25821	72200	87300	4600	6500			43.0	40.5	65.0	68.0	1.6	0.8	8.2	0.309	0.167
	76.200	29.370	28.575	23.812	1.5	3.3	31597	31520	80000	96000	5000	6800			46.0	43.5	64.0	72.0	1.5	3.3	7.7	0.400	0.230
	76.200	29.370	28.575	23.813	3.6	3.3	31593	31520	80900	97400	4500	6300			55.0	45.0	64.0	72.0	3.6	3.2	7.8	0.383	0.238
	80.167	29.370	30.391	23.813	3.6	3.2	3379	3320	91000	106000	4200	5900			59.0	48.0	66.0	75.0	3.6	3.2	10.7	0.503	0.220
34.987	59.131	15.875	16.764	11.938	1.3	1.27	L68149	L68110	35700	48500	5300	7500			45.5	39.0	53.0	56.0	3.5	1.2	2.7	0.112	0.057
	59.975	15.875	16.764	11.938	1.3	1.27	L68149	L68111	35700	48500	5300	7500			45.5	39.0	53.0	56.0	3.5	1.2	2.7	0.112	0.064
35.000	59.131	15.875	16.764	11.938	1.3	1.3	L68149	34000	34000	46000	6000	8000			45.5	39.0	52.0	56.0	3.5	1.3	2.5	0.110	0.055
36.487	73.025	23.812	24.608	19.050	1.5	0.8	25880	25821	73000	88500	5200	7100			44.0	42.0	65.0	68.0	1.5	0.8	8.1	0.300	0.165
36.512	69.012	19.050	19.050	15.083	3.5	0.8	13682	13620	47000	60000	5300	7100			49.5	43.0	62.0	65.0	3.5	0.8	3.0	0.190	0.105
	76.200	29.370	28.575	23.020	3.5	3.3	HM89449	HM89410	79500	108000	5000	6800			54.0	44.6	62.0	73.0	3.5	3.3	5.6	0.370	0.250
	85.725	30.162	30.162	23.813	0.8	3.3	3878	3820	91000	115000	4300	6000			57.0	50.3	73.0	81.0	0.8	3.3	8.2	0.525	0.280

Note : when load center is (-), and it is out of inner ring plane

d: 36.513 ~ 42.875 mm

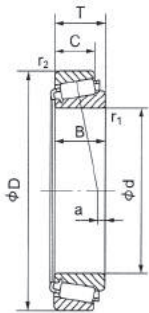

Principal Dimensions (mm)							Bearing Designations		Basic Load Ratings (N)		Limiting Speed (rpm)	
d	D	T	B	C	r <sub>1</sub> (min)	r <sub>2</sub> (min)	Cone	Cup	Dynamic Cr	Static Cor	Grease	Oil
36.513	93.663	31.750	31.750	26.195	1.6	3.2	46143	46368	105000	134000	3600	5100
38.000	63.000	17.000	17.000	13.500	3.56	1.27	J169349	J169310	43500	58200	5000	7000
38.100	63.500	12.700	11.908	9.525	1.5	0.8	13889	13830	27200	34000	5400	7300
	65.088	18.034	18.288	13.70	2.3	1.3	LM29749	LM29710	45000	60000	5400	7500
	65.088	18.034	18.288	13.970	2.36	1.17	LM29749	LM29710	42900	56500	4900	6800
	65.088	18.034	18.288	13.970	1.2	1.17	LM29748	LM29710	42900	56500	4900	6800
	69.012	19.050	19.050	15.083	3.5	2.3	13685	13621	47000	60000	5300	7100
	76.200	23.812	25.654	19.050	3.5	0.8	2788	2729	68000	81000	5000	6700
	76.200	23.812	25.654	19.050	3.5	3.3	2788	2720	68000	81000	5000	6700
	76.200	23.813	25.654	19.050	3.6	3.2	2788R	2720	74100	82200	4500	6300
	79.375	23.813	25.400	19.050	0.8	0.8	26878R	26822	81100	105000	4200	5900
	79.375	29.370	29.771	23.813	3.6	3.2	3490	3420	87400	105000	4300	6100
	80.167	29.370	30.391	23.812	3.5	3.3	3381	3320	86000	106000	4800	6400
	88.501	26.988	29.083	22.225	3.6	1.6	418	414	98100	112000	4000	5700
39.688	73.025	23.812	25.654	19.050	3.5	0.8	2789	2735	68000	81000	5000	6700
	73.025	25.654	22.098	21.336	0.8	2.3	M201047	M201011	63000	81000	5000	6700
	76.200	26.813	25.654	19.050	3.6	3.2	2789R	2720	74100	92200	4500	6300
40.987	67.975	17.500	18.000	13.500	1.6	1.6	LM300849	LM300311	44000	59500	4600	6500
41.275	73.025	16.667	17.462	12.700	3.5	1.5	18590	18520	46500	57000	4800	6700
	73.025	16.667	17.463	12.700	3.6	1.6	18590	18520	45900	55800	4300	6100
	73.431	19.558	19.812	14.732	3.5	0.8	LM501349	LM501310	55500	69000	4900	6700
	73.431	19.558	19.812	14.732	3.6	0.8	LM501349	LM501310	57800	73000	4400	6100
	73.431	21.430	19.812	16.604	3.6	0.8	LM501349	LM501314	57800	73000	4400	6100
	76.200	18.009	17.384	14.288	1.6	1.6	11162R	11300	51600	63300	4300	6000
	76.200	22.225	23.020	17.462	3.5	0.8	24780	24720	63500	78500	4800	6600
	76.200	25.400	23.020	20.638	3.6	2.4	24780R	24721	66300	83300	4000	5600
	79.375	23.812	25.400	19.050	3.5	0.8	26882	26822	75000	94500	4700	6300
	80.167	25.400	25.400	20.638	3.6	3.2	26882R	26820	81100	105000	4200	5900
	80.167	29.370	30.391	23.813	0.8	3.2	3384	3320	91000	106000	4200	5900
	87.313	30.163	30.886	23.813	1.6	3.2	3585R	3525	95800	120000	3900	5400
	90.488	39.688	40.386	33.338	3.6	3.2	4388	4335	132000	169000	3800	5600
42.863	87.312	30.162	30.886	23.812	3.6	3.2	3579R	3525	95800	120000	3900	5400
42.875	80.000	21.000	22.406	17.826	3.5	1.3	342S	332	69000	76000	4500	6300
	82.931	23.812	25.400	19.050	3.5	0.8	25577	25520	78500	98000	4500	6000
	82.931	26.988	25.400	22.225	3.5	2.3	25577	25523	78500	98000	4500	6000
	83.058	23.812	25.400	19.050	3.5	3.3	25577	25521	78500	98000	4500	6000

Note : when load center is (-), and it is out of inner ring plane

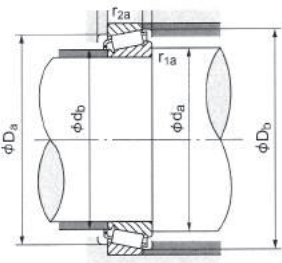

Abutment and Fillet Dimensions (mm)							Eff. Load Centers (mm) a	Weight (kg)	
d <sub>a</sub> (min)	d <sub>b</sub> (min)	D <sub>a</sub> (max)	D <sub>b</sub> (max)	r <sub>1a</sub> (max)	r <sub>2a</sub> (max)			Cone	Cup
68.0	56.0	72.0	86.0	1.6	3.2	7.7		0.728	0.412
49.0	41.0	60.0	56.5	3.5	1.2	2.4		0.128	0.072
45.0	42.5	59.0	60.0	1.5	0.8	0.8		0.108	0.045
46.0	42.5	59.0	62.0	2.3	1.3	4.2		0.155	0.080
46.0	42.5	59.0	62.0	2.4	1.2	4.3		0.158	0.080
49.0	42.5	59.0	62.0	3.5	1.2	4.3		0.154	0.080
49.5	43.0	61.0	65.0	3.5	2.3	3.0		0.185	0.103
50.0	43.5	68.0	70.0	3.5	0.8	8.0		0.310	0.187
50.0	43.5	66.0	70.0	3.5	3.3	8.0		0.310	0.185
50.0	43.5	61.0	69.0	3.6	3.2	8.1		0.305	0.190
60.0	50.0	65.0	73.0	0.8	0.8	7.5		0.397	0.185
52.0	45.9	67.0	74.0	3.6	3.2	8.6		0.415	0.262
46.5	45.5	77.0	74.8	3.5	3.3	18.5		0.445	0.215
51.0	44.5	70.0	80.0	3.6	1.6	10.1		0.522	0.329
52.0	45.0	65.0	70.0	3.5	0.8	8.0		0.290	0.170
45.5	47.8	64.0	69.0	0.8	2.3	5.9		0.255	0.183
52.0	45.0	61.0	69.0	3.6	3.2	8.1		0.285	0.190
55.0	47.0	58.0	64.0	3.5	1.6	3.6		0.157	0.082
53.0	46.0	66.0	69.0	3.5	1.5	2.8		0.208	0.084
53.0	46.0	66.0	69.0	3.6	1.6	2.2		0.198	0.087
53.0	46.8	67.0	70.0	3.5	0.8	3.4		0.220	0.108
53.0	46.5	46.5	70.0	3.6	0.8	3.5		0.226	0.109
53.0	46.5	46.5	69.0	3.6	0.8	3.5		0.226	0.129
49.0	46.5	46.5	72.0	1.6	1.6	0.5		0.219	0.130
54.0	47.0	47.0	72.0	3.5	0.8	1.6		0.275	0.189
54.0	47.0	47.0	72.0	3.6	2.4	4.8		0.271	0.191
54.0	47.0	47.0	74.0	3.5	0.8	7.5		0.340	0.185
60.0	50.0	50.0	73.0	3.6	3.2	7.5		0.350	0.223
59.0	48.0	48.0	75.0	0.8	3.2	10.7		3.416	0.220
63.0	54.0	54.0	81.0	1.6	3.2	9.7		0.527	0.308
57.0	54.0	54.0	85.0	3.6	3.2	14.1		0.767	0.463
63.0	75.0	54.0	81.0	3.6	3.2	9.7		0.499	0.308
54.0	47.5	47.5	75.0	3.5	1.3	6.2		0.295	0.145
50.0	49.0	49.0	77.0	3.5	0.8	6.2		0.380	0.200
55.0	49.0	49.0	77.0	3.5	2.3	9.4		0.380	0.245
55.0	49.0	49.0	77.0	3.5	3.3	6.2		0.380	0.199

d: 44.450 ~ 50.00 mm

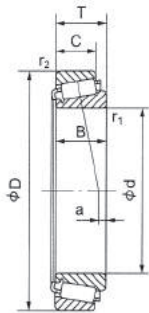

Principal Dimensions (mm)							Bearing Designations		Basic Load Ratings (N)		Limiting Speed (rpm)	
d	D	T	B	C	r <sub>1</sub> (min)	r <sub>2</sub> (min)	Cone	Cup	Dynamic Cr	Static Cor	Grease	Oil
44.450	82.931	23.812	25.400	19.050	3.5	0.8	25580	25520	78500	98000	4500	6000
	82.931	26.988	25.400	22.225	3.5	2.3	25580	25523	78500	98000	4500	6000
	83.058	23.812	25.400	19.050	3.5	3.3	25580	25521	78500	98000	4500	6000
	87.312	60.162	30.886	23.812	3.5	3.3	3578	3525	90000	110000	4300	6000
	87.313	30.163	30.886	23.813	3.6	3.2	3548R	3525	95800	120000	3900	5400
	88.900	30.163	29.370	23.020	3.6	3.3	HM803149	HM803110	99600	128000	3800	5400
	90.119	23.000	21.926	21.808	3.6	2.4	355X	352	71800	81700	3800	5400
	92.075	30.163	29.370	23.020	3.6	3.2	HM803149	HM803112	99600	125000	3800	5440
	93.264	30.163	30.302	23.813	3.6	3.2	3782	3720	103000	137000	3500	4900
	95.250	30.958	28.575	22.225	3.6	0.8	HM903249	HM903210	99700	120000	3700	5100
44.983	95.250	30.958	28.301	20.638	1.2	0.8	53176	53375	88700	98400	3700	5200
	112.713	30.163	26.909	50.638	3.5	3.3	55175	55443	92000	108000	3100	4300
	114.300	44.450	44.450	34.925	3.6	3.2	65385	65320	189000	230000	3100	4400
	93.264	30.163	30.302	23.813	3.6	3.2	3776	3720	103000	137000	3500	4900
	73.431	19.558	19.812	15.748	3.5	0.8	LM102949	LM102910	55500	78000	4700	6400
	77.788	198.542	19.842	15.080	3.6	0.8	LM603049	LM603011	57100	73500	4100	5700
	77.788	21.430	19.842	16.667	3.6	0.8	LM606049	LM603012	57100	73500	4100	5700
	82.931	23.812	25.400	19.050	3.5	0.8	25590	25520	78500	98000	4500	6000
	82.931	26.988	25.400	22.225	3.5	2.3	25590	25523	78500	98000	4500	6000
	79.375	17.463	17.463	13.495	2.8	1.6	18690	18620	47100	59100	4000	5600
45.242	85.000	20.638	21.692	17.462	2.3	1.3	359S	354A	69000	78000	4300	6000
	93.264	30.163	30.302	23.813	3.6	3.2	37790	3720	103000	137000	3500	4900
	101.600	34.925	36.068	26.988	3.5	3.3	528	522	139000	171000	3700	5000
	107.950	36.513	36.957	28.575	3.6	3.2	536	532X	138000	172000	3200	4400
	111.125	30.162	26.909	20.638	3.5	3.3	55187	55437	92000	108000	3100	4300
	93.264	30.162	30.302	23.812	3.5	0.8	3781	3730	102000	134000	3800	5300
	103.188	43.658	44.475	36.512	3.5	3.3	5395	5335	177000	245000	3700	5000
	114.300	44.450	44.450	36.068	3.5	3.3	HH506348	HH506310	199000	243000	3500	4700
	82.000	21.500	21.500	17.000	3.0	0.5	JLM104948	JLM104910	71700	97900	3800	5300

Note : when load center is (-), and it is out of inner ring plane

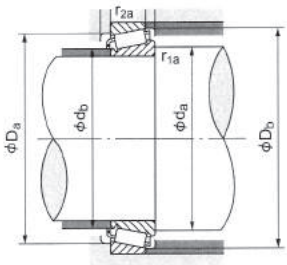

Abutment and Fillet Dimensions (mm)							Eff. Load Centers (mm) a	Weight (kg)	
d <sub>a</sub> (min)	d <sub>b</sub> (min)	D <sub>a</sub> (max)	D <sub>b</sub> (max)	r <sub>1a</sub> (max)	r <sub>2a</sub> (max)			Cone	Cup
57.0	50.0	74.0	77.0	3.5	0.8	6.2	0.355	0.200	
57.0	50.0	72.0	77.0	3.5	2.3	9.4	0.355	0.245	
57.0	50.0	72.0	77.0	3.5	3.3	6.2	0.355	0.100	
57.0	51.0	72.0	81.0	3.5	3.3	10.2	0.476	0.305	
57.0	51.0	75.0	81.0	3.6	3.2	9.7	0.476	0.308	
62.0	53.4	75.0	85.0	3.6	3.2	4.1	0.547	0.326	
63.0	55.0	74.0	80.0	3.6	2.4	5.1	0.336	0.325	
62.0	53.4	72.0	84.0	3.6	3.2	4.1	0.517	0.407	
71.0	59.0	67.0	88.0	3.6	3.2	8.0	0.651	0.296	
65.0	54.0	82.0	91.0	3.6	0.8	0.1	0.609	0.389	
59.0	52.5	81.0	89.0	1.2	0.8	1.0	0.557	0.367	
67.0	60.0	84.0	105.0	3.5	3.3	-71	0.820	0.500	
79.0	59.0	97.0	107.0	3.6	3.2	12.5	1.466	0.884	
59.0	53.0	82.0	88.0	3.6	3.2	8.0	0.642	0.296	
56.0	50.0	98.0	70.0	3.5	0.8	4.7	0.208	0.100	
57.0	50.0	71.0	74.0	3.6	0.8	2.3	0.242	0.122	
57.0	50.0	71.0	74.0	3.6	0.8	2.3	0.241	0.141	
58.0	51.0	74.0	77.0	3.5	0.8	6.2	0.340	0.200	
58.0	51.0	72.0	77.0	3.5	2.3	6.2	0.340	0.245	
56.0	51.0	71.0	74.0	2.8	1.6	1.5	0.206	0.126	
55.0	51.0	77.0	80.0	2.3	1.3	4.9	0.330	0.160	
71.0	59.0	82.0	88.0	3.6	3.2	8.0	0.596	0.296	
62.0	55.0	89.0	95.0	3.5	3.3	12.7	0.890	0.410	
76.0	64.0	94.0	100.0	3.6	3.2	12.3	1.03	0.583	
69.0	62.0	82.0	105.0	3.5	3.3	-7.1	0.825	0.510	
62.0	56.0	84.0	88.0	3.5	0.8	8.4	0.650	0.295	
66.0	60.0	89.0	97.0	3.5	3.3	27.3	1.13	0.640	
71.0	61.0	97.0	107.0	3.5	3.3	31.5	1.70	0.850	
60.0	55.0	76.0	78.0	3.0	0.5	5.3	0.305	0.129	



d: 50.800 ~ 57.150 mm

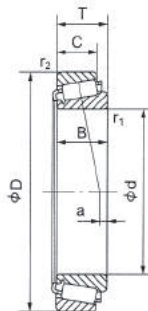

Principal Dimensions (mm)							Bearing Designations		Basic Load Ratings (N)		Limiting Speed (rpm)	
d	D	T	B	C	r <sub>1</sub> (min)	r <sub>2</sub> (min)	Cone	Cup	Dynamic Cr	Static Cor	Grease	Oil
50.800	82.000	21.976	22.225	17.000	3.6	0.5	LM104949	JLM104910	61200	84300	3700	5200
	82.550	21.590	22.225	16.510	3.5	1.3	LM104949	LM104911	71000	96000	4300	5700
	82.931	21.590	22.225	16.510	3.6	1.2	LM104949	LM104912	61200	84300	3700	5200
	85.000	17.462	17.462	13.495	3.5	1.5	18790	18720	44000	58500	4000	5600
	88.900	17.462	17.462	13.495	3.5	1.3	18790	18724	44000	58500	4000	5300
	88.900	20.638	22.225	16.513	1.5	1.3	368	362A	74500	89000	4000	5600
	88.900	20.638	22.225	16.513	3.6	1.3	368A	362A	74300	87300	3700	5200
	92.075	24.608	25.400	19.845	3.6	0.8	28580R.L	28521.L	84800	119000	3500	4900
	93.264	30.162	30.302	23.812	3.5	0.8	3780	3730	102000	134000	3800	5300
	93.264	30.163	30.302	23.813	3.6	3.2	3780	3720	103000	137000	3500	4900
	101.600	31.750	31.750	25.400	3.5	3.3	49585	49520	107000	128000	3600	5000
	101.600	34.925	36.068	26.988	0.8	3.3	529	522	139000	169000	3700	5000
	104.775	30.162	30.958	23.812	6.4	3.3	45284	45220	131000	171000	3500	4700
	104.775	36.212	36.512	28.575	3.5	3.3	HM807046	HM807010	147000	201000	3500	4800
	107.950	36.512	36.957	58.575	3.5	3.3	537	532X	139000	173000	3600	4800
	111.125	30.162	26.909	50.638	3.5	3.3	55200	55437	92000	108000	3100	4300
	122.238	38.100	36.678	30.162	2.3	3.3	555	553X	149000	197000	3000	4100
	123.825	36.512	32.791	25.400	3.5	3.3	72200	72487	135000	148000	2900	4100
127.000	44.450	44.450	34.925	3.5	3.3	65200	65500	198000	258000	3100	4300	
52.388	92.075	24.608	25.400	19.845	3.6	0.8	28584R	28521	84800	119000	3500	4900
53.975	96.838	21.001	21.946	15.875	1.6	0.8	389A	382A	80400	101000	3300	4600
	98.425	21.000	21.946	17.826	0.8	0.8	389A	382	74500	91500	3600	5000
	104.775	30.162	29.317	24.605	3.5	3.3	456	453X	116000	150000	3400	4800
	104.775	36.512	36.512	28.575	3.5	3.3	HM807049	HM807010	147000	201000	3500	4800
	112.712	30.162	30.163	23.812	3.5	3.3	39578	39520	126000	168000	3100	4300
	120.650	41.275	41.275	31.750	3.5	3.3	621	612	163000	198000	3300	4400
	123.825	38.100	36.678	30.162	3.5	3.3	557S	552A	149000	197000	3000	4100
	127.000	44.450	44.450	34.925	3.5	3.3	65212	65500	198000	258000	3100	4300
55.000	90.000	23.000	23.000	18.500	1.5	0.5	JLM506849E	JLM506810E	81400	115000	3500	4900
55.562	122.238	43.658	43.764	36.512	1.3	3.3	5566	5535	178000	263000	3000	4000
55.563	97.630	24.608	24.608	19.446	3.6	0.8	28680	28622	89600	131000	3300	4600
57.150	96.838	21.001	21.946	15.875	3.6	0.8	387A	382A	80400	101000	4200	5900
	97.630	24.608	24.608	19.446	3.6	0.8	28682	28622	89600	131000	3300	4600
	104.775	30.163	29.317	24.605	2.4	3.2	462	453X	109000	144000	3100	4300
	104.775	30.162	30.958	23.812	2.3	0.8	45290	45221	131000	171000	3500	4700
	104.775	30.163	29.317	24.605	3.6	3.2	469	453X	109000	144000	3100	4300
	110.000	21.999	21.996	18.825	2.4	1.2	390	394A	86400	116000	2800	4000
	112.712	30.162	30.048	23.812	3.5	3.3	3979	3920	118000	172000	3200	4300
	112.713	30.163	30.163	23.813	7.9	3.2	39581	39520	147000	207000	2800	3900
	117.475	30.162	30.162	23.812	3.5	3.3	33225	33462	112000	168000	3000	4000
	117.475	33.338	31.750	23.812	3.5	3.3	66225	66462	118000	132000	3100	4100
	122.238	38.100	36.678	30.162	3.5	3.3	555S	553X	149000	197000	3000	4100
	127.000	44.450	44.450	34.925	3.5	3.3	65225	65500	198000	258000	3100	4200
136.525	41.275	41.275	31.750	3.5	3.3	635	632	183000	246000	2800	3800	
149.225	53.975	54.229	44.450	3.5	3.3	6455	6420	284000	410000	2500	3400	

Note : when load center is (-), and it is out of inner ring plane

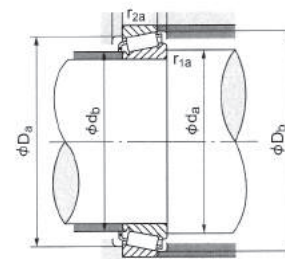

Abutment and Fillet Dimensions (mm)							Eff. Load Centers (mm) a	Weight (kg)	
d <sub>a</sub> (min)	d <sub>b</sub> (min)	D <sub>a</sub> (max)	D <sub>b</sub> (max)	r <sub>1a</sub> (max)	r <sub>2a</sub> (max)			Cone	Cup
62.0	55.0	76.0	78.0	3.6	0.5	5.2	0.288	0.129	
62.0	55.0	75.0	78.0	3.5	1.3	3.9	0.285	0.150	
62.0	55.0	72.0	78.0	3.6	1.2	5.2	0.287	0.140	
62.0	56.0	77.0	80.0	3.5	1.5	0.7	0.235	0.134	
62.0	56.0	75.5	80.5	3.5	1.3	0.7	0.235	0.134	
58.0	56.0	81.0	84.0	1.5	1.3	4.2	0.345	0.165	
62.0	56.0	84.0	84.0	3.6	1.2	4.6	0.329	0.166	
73.0	61.0	76.0	86.0	3.6	0.8	4.7	0.455	0.247	
64.0	58.0	84.0	88.0	3.5	0.8	8.2	0.558	0.295	
64.0	58.0	82.0	88.0	3.6	3.2	8.0	0.539	0.296	
66.0	59.0	88.0	96.0	3.5	3.3	7.1	0.750	0.385	
59.0	58.0	89.0	95.0	0.8	3.3	12.7	0.830	0.410	
71.0	59.0	95.0	99.0	6.4	3.3	7.9	0.825	0.410	
70.0	63.1	89.0	100.0	3.5	3.3	7.4	0.970	0.500	
65.0	59.0	94.0	100.0	3.5	3.3	11.7	0.970	0.570	
71.0	63.9	92.0	105.0	3.5	3.3	-7.1	0.770	0.510	
66.0	62.0	108.0	115.0	2.3	3.3	9.4	1.50	0.690	
74.0	65.9	102.0	116.0	3.5	3.3	-1.3	1.24	0.785	
75.0	69.0	107.0	119.0	3.5	3.3	9.4	1.87	1.03	
73.0	61.0	76.0	87.0	3.6	0.8	4.7	0.430	0.247	
75.0	66.0	89.0	92.0	1.6	0.8	3.6	0.475	0.179	
69.0	71.0	90.0	92.0	0.8	0.8	3.0	0.380	0.225	
67.0	63.0	92.0	98.0	3.5	3.3	7.0	0.740	0.375	
73.0	63.1	89.0	95.0	3.5	3.3	7.4	0.890	0.500	
77.0	61.0	101.0	107.0	3.5	3.3	6.6	0.900	0.360	
7.0	63.0	105.0	110.0	3.5	3.3	26.9	1.49	0.735	
71.0	65.0	109.0	116.0	3.5	3.3	9.2	1.50	0.750	
77.0	71.0	107.0	119.0	3.5	3.3	9.4	1.80	1.03	
74.0	67.0	108.0	117.0	3.5	3.3	19.5	2.06	1.25	
72.0	62.0	76.0	87.0	1.5	0.5	2.9	0.377	0.184	
70.0	68.0	106.0	116.0	1.3	3.3	12.1	1.76	0.811	
68.0	62.0	88.0	92.0	3.6	0.8	3.4	0.490	0.270	
69.0	62.0	89.0	92.0	3.6	0.8	3.6	0.425	0.179	
76.0	66.0	88.0	92.0	3.6	0.8	3.4	0.463	0.270	
67.0	63.0	92.0	98.0	2.4	3.2	6.6	0.678	0.382	
68.0	65.0	95.0	99.0	2.3	0.8	8.0	0.765	0.350	
70.0	63.0	92.0	98.0	3.6	3.2	6.6	0.678	0.382	
86.0	77.0	101.0	104.5	2.4	1.2	0.7	0.677	0.262	
72.0	66.0	99.0	106.0	3.5	3.3	4.6	0.940	0.460	
81.0	66.0	101.0	107.0	7.9	3.2	6.9	1.03	0.363	
74.0	68.0	104.0	112.0	3.5	3.3	2.4	1.05	0.440	
72.0	63.0	98.0	113.0	3.5	3.3	-0.1	0.970	0.540	
73.0	67.0	108.0	115.0	3.5	3.3	9.4	1.45	0.690	
80.0	71.0	107.0	119.0	3.5	3.3	9.3	1.75	1.03	
75.0	69.0	118.0	125.0	3.5	3.3	11.2	2.02	1.01	
81.0	75.0	129.0	140.0	3.5	3.3	15.1	3.45	1.65	

d: 58.738 ~ 65.088 mm

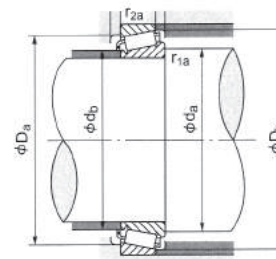
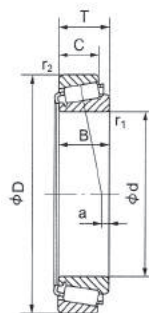

Principal Dimensions (mm)							Bearing Designations		Basic Load Ratings (N)		Limiting Speed (rpm)				Abutment and Fillet Dimensions (mm)						Eff. Load Centers (mm) a	Weight (kg)	
d	D	T	B	C	r <sub>1</sub> (min)	r <sub>2</sub> (min)	Cone	Cup	Dynamic Cr	Static Cor	Grease	Oil			d <sub>a</sub> (min)	d <sub>b</sub> (min)	D <sub>a</sub> (max)	D <sub>b</sub> (max)	r <sub>1a</sub> (max)	r <sub>2a</sub> (max)		Cone	Cup
58.738	112.712	30.162	30.048	23.812	3.5	3.3	3981	3920	118000	172000	3200	4300			73.0	67.0	99.0	106.0	3.5	3.3	4.5	0.890	0.460
	127.000	44.450	44.450	34.925	3.5	3.3	65231	65500	198000	258000	3100	4200			81.0	71.0	107.0	119.0	3.5	3.3	9.3	1.71	1.03
59.987	134.983	33.449	30.925	21.948	3.6	3.6	HM911244	HM911216	153000	181000	2600	3700			100.0	75.0	98.0	122.0	3.6	3.6	-7.1	1.35	0.823
60.325	100.000	25.400	25.400	19.845	3.6	3.2	28985	28921	91400	137000	3100	4300			73.0	67.0	89.0	96.0	3.6	3.2	2.6	0.527	0.237
	101.600	25.400	25.400	19.845	3.6	3.2	28985	28920	91400	137000	3100	4300			73.0	67.0	89.0	96.0	3.6	3.2	2.6	0.526	0.276
	112.713	30.162	30.048	23.812	3.5	0.8	3980	3925	118000	172000	3200	4300			74.0	68.0	101.0	106.0	3.5	0.8	4.5	0.90	0.450
	122.238	38.100	38.354	29.718	8.0	1.5	HM212044	HM212010	187000	243000	3000	4100			85.0	70.0	110.0	116.0	8.0	1.5	10.9	1.45	0.600
	127.000	36.512	36.512	26.988	3.5	1.5	HM813841	HM813811	113000	149000	2900	3800			80.0	73.0	113.0	121.0	3.5	1.5	3.7	1.58	0.625
	130.175	36.512	33.338	23.812	5.0	3.3	HM911245	HM911210	146000	171000	2700	3600			87.0	74.0	109.0	123.6	5.0	3.3	-5.2	1.48	0.685
	130.175	41.275	41.275	31.750	3.5	3.3	637	633	183000	246000	2800	3800			78.0	72.0	116.0	124.0	3.5	3.3	11.2	1.89	0.705
	135.755	53.975	56.007	44.450	3.5	3.3	6376	6320	263000	360000	2800	3800			81.0	74.0	117.0	126.0	3.5	3.3	19.2	2.45	1.40
61.912	136.525	46.038	46.038	36.512	3.5	3.3	H715332	H715311	184000	280000	2600	3600			84.0	78.0	118.0	132.0	3.5	3.3	8.5	2.53	1.02
	110.000	22.000	21.996	18.824	0.8	1.3	392	394A	87500	117000	3200	4300			70.0	69.0	101.0	104.5	0.8	1.3	0.8	0.615	0.265
	122.238	38.100	36.678	30.162	3.5	3.3	554	553X	149000	197000	3000	4100			73.0	67.0	108.0	115.0	3.5	3.3	9.4	1.40	0.690
	139.700	46.038	46.038	36.512	3.5	3.3	H715334	H715310	184000	280000	2600	3600			86.0	79.0	120.0	133.0	3.5	3.3	8.5	2.48	1.15
	146.050	41.275	39.688	25.400	3.5	3.3	H913842	H913810	191000	221000	2400	3300			90.0	82.4	124.0	138.0	3.5	3.3	-4.3	2.25	0.900
	94.458	19.050	19.050	15.083	1.5	1.5	L610549	L610510	49000	80000	3600	4800			71.0	69.0	86.0	91.0	1.5	1.5	-0.7	0.295	0.156
	107.950	25.400	25.400	19.050	1.6	0.8	59586	29522	82800	143000	2800	4000			73.0	71.0	91.0	104.0	1.6	0.8	0.7	0.646	0.286
	107.950	25.400	25.400	19.050	3.5	3.3	29585	29520	94500	144000	3200	4300			77.0	71.0	96.0	103.0	3.5	3.3	0.8	0.640	0.280
63.500	110.000	22.000	21.996	18.824	3.5	1.3	395	394A	87500	117000	3200	4300			77.0	70.0	101.0	104.5	3.5	1.3	0.8	0.565	0.265
	110.000	25.400	25.400	19.050	3.5	1.3	29585	29521	94500	144000	3200	4300			77.0	71.0	99.0	104.0	3.5	1.3	0.8	0.640	0.335
	112.712	30.162	30.048	23.812	3.5	0.8	3982	3925	118000	172000	3200	4300			77.0	71.0	101.0	106.0	3.5	0.8	4.5	0.775	0.450
	112.713	30.163	30.463	23.813	3.6	3.2	39585	39520	147000	207000	2800	3900			77.0	71.0	101.0	107.0	3.6	3.2	6.9	0.907	0.363
	112.713	30.163	30.048	23.813	3.6	3.2	3982	3920	111000	164000	2800	4000			88.0	76.0	99.0	106.0	3.6	3.2	4.3	0.772	0.458
	120.000	29.002	29.007	23.444	3.5	3.3	483	472A	119000	161000	3000	4000			78.0	72.0	106.0	114.0	3.5	3.3	4.0	0.985	0.445
	120.000	29.794	30.162	23.444	0.8	0.8	33251	33472	112000	168000	3000	4000			73.0	72.0	107.0	113.0	0.8	0.8	2.6	1.03	0.510
	122.238	38.100	38.354	29.718	7.0	3.3	HM212047	HM212011	187000	243000	3000	4100			87.0	73.0	108.0	116.0	7.0	3.3	10.9	1.45	0.600
	122.238	38.100	38.354	29.718	7.1	3.2	HM212047UR	HM212011UR	191000	249000	2700	3800			90.0	77.0	102.0	115.0	7.1	3.2	10.8	1.35	0.605
	127.000	36.512	36.512	26.988	3.5	1.5	HM813842	HM813811	113000	149000	2900	3800			82.0	76.0	113.0	121.0	3.5	1.5	3.7	1.40	0.715
	130.175	41.275	41.275	31.750	3.5	3.3	639	633	183000	246000	2800	3800			81.0	74.0	116.0	124.0	3.5	3.3	11.2	1.79	0.705
	136.525	41.275	41.275	31.750	3.5	3.3	H414235	H414210	231000	300000	2700	3700			82.0	78.0	121.0	129.0	3.5	3.3	10.9	1.95	0.795
64.963	136.525	46.038	46.038	36.512	3.5	3.3	H715336	H715311	184000	280000	2600	3600			87.0	80.0	118.0	132.0	3.5	3.3	8.5	2.45	1.02
	140.030	36.512	33.236	23.520	2.3	2.3	78250	78551	145000	172000	2500	3500			85.0	78.9	117.0	132.0	2.3	2.3	-8.0	1.50	0.925
	150.089	44.450	46.673	36.512	3.5	3.3	745S	742	252000	345000	2400	3200			88.0	82.0	134.0	142.0	3.5	3.3	11.9	2.90	1.06
	127.000	36.512	36.170	28.575	3.5	3.3	569	563	165000	232000	2800	3800			81.0	74.0	112.0	120.0	3.5	3.3	8.1	1.45	0.650
	120.000	39.000	38.500	32.000	3.0	2.5	JH211749E	JH211710E	189000	255000	2700	3800			91.0	75.0	99.0	114.0	3.0	2.5	11.1	1.28	0.628
	135.755	53.975	56.007	44.450	3.5	3.3	6379	6320	263000	360000	2800	3800			84.0	77.4	117.0	126.0	3.5	3.3	19.2	2.25	1.40
	136.525	46.038	46.038	36.512	3.5	3.3	H715340	H715311	184000	280000	2600	3600			88.0	82.0	118.0	132.0	3.5	3.3	8.5	2.35	1.02
	136.525	46.038	46.038	36.512	3.5	3.3	H715340	H715311	184000	280000	2600	3600			88.0	82.0	118.0	132.0	3.5	3.3	8.5	2.35	1.02

Note : when load center is (-), and it is out of inner ring plane

d: 66.675 ~ 71.438 mm

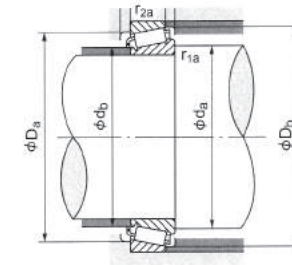
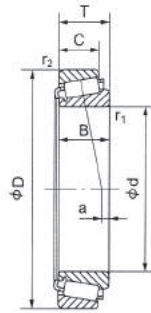

Principal Dimensions (mm)							Bearing Designations		Basic Load Ratings (N)		Limiting Speed (rpm)		Abutment and Fillet Dimensions (mm)						Eff. Load Centers (mm) a		Weight (kg)	
d	D	T	B	C	r <sub>1</sub> (min)	r <sub>2</sub> (min)	Cone	Cup	Dynamic Cr	Static Cor	Grease	Oil	d <sub>a</sub> (min)	d <sub>b</sub> (min)	D <sub>a</sub> (max)	D <sub>b</sub> (max)	r <sub>1a</sub> (max)	r <sub>2a</sub> (max)			Cone	Cup
66.675	110.000	21.999	21.996	18.824	3.6	1.2	395S	394A	86400	116000	2800	4000	79.0	73.0	101.0	104.5	3.6	1.2	0.7		0.516	0.262
	110.000	21.999	21.996	18.824	0.8	1.2	395A	394A	86400	116000	2800	4000	73.0	73.0	101.0	104.5	0.8	1.2	0.7		0.521	0.262
	112.713	30.163	30.048	23.813	3.6	3.2	3984	3920	111000	164000	2800	4000	88.0	76.0	99.0	106.0	3.6	3.2	4.3		0.692	0.458
	112.713	30.163	30.163	23.813	3.6	3.2	39590	39520	147000	207000	2800	3900	80.0	74.0	101.0	107.0	3.6	3.2	6.9		0.827	0.363
	112.713	30.163	30.048	23.813	5.6	3.2	3994	3920	111000	164000	2800	4000	88.0	76.0	99.0	106.0	5.6	3.2	4.3		0.692	0.458
	117.475	30.162	30.162	23.813	3.5	3.3	33262	33462	112000	168000	3000	4000	81.0	75.0	104.0	112.0	3.5	3.3	2.8		0.910	0.440
	122.238	38.100	36.678	30.162	3.5	3.3	560	553X	149000	197000	3000	4000	81.0	75.0	108.0	115.0	3.5	3.3	9.4		1.15	0.690
	122.238	38.100	68.354	29.718	3.5	1.5	HM212049	HM212010	187000	243000	3000	4100	82.0	75.5	110.0	116.0	3.5	1.5	10.9		1.25	0.600
	122.238	38.100	38.354	29.718	3.6	3.2	HM212049	HM212011	191000	249000	2700	3800	82.0	75.5	108.0	116.0	3.6	3.2	10.8		1.25	0.605
	136.525	41.275	41.275	31.750	3.5	3.3	H414242	H414210	231000	300000	2700	3700	85.0	81.0	121.0	129.0	3.5	3.3	10.9		1.95	0.795
66.262	136.525	46.039	46.038	36.512	3.5	3.3	H715341	H715311	184000	280000	2600	3600	89.0	83.0	118.0	132.0	3.5	3.3	8.5		2.30	1.02
	110.000	22.000	21.996	18.824	2.3	1.3	399A	394A	87500	117000	3200	4300	78.0	74.0	101.0	104.5	2.3	1.3	0.8		0.495	0.265
	117.475	30.162	30.162	23.812	3.5	3.3	33269	33462	112000	168000	3000	4000	82.0	76.0	104.0	112.0	3.5	3.3	2.8		0.900	0.440
	120.000	29.005	29.007	23.444	3.5	3.3	480	472A	119000	161000	3000	4000	82.0	75.0	106.0	114.0	3.5	3.3	4.0		0.890	0.445
	122.238	38.100	36.678	30.162	3.5	3.3	560S	553X	149000	197000	3000	4000	83.0	76.0	108.0	115.0	3.5	3.3	9.4		1.10	0.690
	135.525	41.275	41.275	31.750	3.5	3.3	H414245	H414210	231000	300000	2700	3700	86.0	82.0	121.0	129.0	3.5	3.3	10.9		1.90	0.795
	136.525	46.038	46.038	36.512	3.5	3.3	H715343	H715311	184000	280000	2600	3600	90.0	84.0	118.0	132.0	3.5	3.3	8.5		2.24	1.02
66.263	152.400	47.625	46.038	31.750	3.5	3.3	9185	9121	245000	279000	2600	3500	90.0	81.3	130.0	145.0	3.5	3.3	3.7		2.57	1.21
	120.000	29.794	29.007	24.237	3.6	2.0	480	472	118000	161000	2700	3700	92.0	80.0	108.0	113.0	3.6	2.0	4.1		0.826	0.494
	123.825	38.100	36.678	30.163	3.6	3.2	560S	552A	162000	223000	2700	3700	91.0	78.0	109.0	116.0	3.6	3.2	9.4		1.07	0.770
	136.525	41.275	41.275	31.750	3.6	3.2	H414245	H414210	228000	295000	2400	3400	86.0	82.0	121.0	129.0	3.6	3.2	11.0		1.91	0.804
	112.712	25.400	25.400	19.050	1.5	3.3	29675	29620	86000	133000	3000	4000	80.0	77.0	101.0	109.0	1.5	3.3	-0.9		0.670	0.290
	117.475	30.163	30.163	23.813	3.6	3.2	33275	33462	118000	179000	2700	3700	84.0	77.0	104.0	112.0	3.6	3.2	2.4		0.824	0.446
	120.000	29.794	29.007	24.237	3.6	2.0	482	475	118000	161000	2700	3700	93.0	81.0	99.0	112.0	3.6	2.0	4.1		0.786	0.494
69.850	120.000	32.545	32.545	26.195	3.5	3.3	47487	47420	123000	167000	3000	4000	84.0	78.0	107.0	114.0	3.5	3.3	6.2		0.960	0.479
	120.000	32.545	32.545	26.195	3.6	0.5	47487R	47420DM	150000	218000	2600	3700	84.0	78.0	107.0	114.0	3.6	0.5	6.0		1.00	0.487
	127.000	36.512	36.512	26.988	3.5	1.5	HM813846	HM813811	113000	149000	2800	3800	88.0	81.0	113.0	121.0	3.5	1.5	3.8		1.27	0.630
	146.050	41.275	39.688	25.400	3.6	3.2	H913849R.F	H913810F	202000	237000	2400	3300	110.0	80.0	112.0	128.0	3.6	3.2	-4.0		2.05	0.907
	146.050	41.275	41.275	31.750	3.5	3.3	655	653	188000	260000	2500	3300	88.0	82.0	131.0	139.0	3.5	3.3	7.9		2.35	0.890
	149.225	53.975	54.229	44.450	5.0	3.3	6454	6420	284000	410000	2500	3400	94.0	85.0	129.0	140.0	5.0	3.3	15.1		2.90	1.65
	150.089	44.450	46.672	36.512	3.5	3.3	745A	742	252000	345000	2400	3200	88.0	82.0	134.0	142.0	3.5	3.3	12.0		2.80	1.06
69.952	121.442	24.608	23.012	17.462	2.0	2.0	34274	34478	85600	110000	2900	3800	81.0	78.0	110.0	116.0	2.0	2.0	-1.2		0.750	0.375
71.438	117.475	30.163	23.163	23.813	3.6	3.2	33281	33462	118000	179000	2700	3700	85.0	79.0	104.0	112.0	3.6	3.2	2.4		0.784	0.446
	120.000	29.794	30.163	23.444	3.6	0.8	33281	33472	118000	179000	2700	3700	85.0	79.0	97.0	112.0	3.6	0.8	2.4		0.787	0.523
	120.000	32.545	32.545	26.195	3.5	3.3	47490	47420	123000	167000	3000	4000	86.0	79.0	107.0	114.0	3.5	3.3	6.2		0.940	0.479
	127.000	36.512	36.512	26.988	3.5	1.5	HM813849	HM813811	113000	149000	2800	3800	89.0	81.9	113.0	121.0	3.5	1.5	3.8		1.35	0.630
	130.175	41.275	41.275	31.750	3.5	3.3	644	633	151000	229000	2800	3800	87.0	81.0	116.0	124.0	3.5	3.3	11.2		1.50	1.05
	133.350	33.338	33.338	26.195	3.5	0.8	47675	47620A	151000	229000	2600	3500	88.0	82.0	121.0	128.0	3.5	0.8	3.8		1.38	0.590
	136.525	41.275	41.275	31.750	3.5	3.3	H414249	H414210	231000	300000	2700	3600	89.0	83.3	121.0	129.0	3.5	3.3	10.9		1.82	0.795
	136.525	41.275	41.275	31.750	3.6	3.2	H414249	H414210	228000	295000	2400	3400	100.0	85.0	212.0	129.0	3.6	3.2	11.0		1.79	0.804
	136.525	41.275	41.275	31.750	6.4	3.2	645	632	197000	267000	2500	3500	98.0	83.0	108.0	123.0	6.4	3.2	11.0		1.45	1.05
	136.525	46.038	46.038	36.512	3.5	3.3	H715345	H715311	184000	280000	2600	3500	93.0	87.0	118.0	132.0	3.5	3.3	8.5		2.07	1.02

Note : when load center is (-), and it is out of inner ring plane





d: 73.025 ~ 84.138 mm

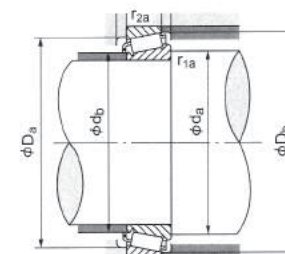
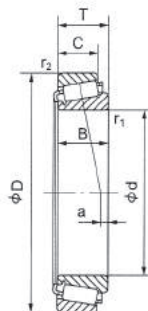

Principal Dimensions (mm)							Bearing Designations		Basic Load Ratings (N)		Limiting Speed (rpm)	
d	D	T	B	C	r <sub>1</sub> (min)	r <sub>2</sub> (min)	Cone	Cup	Dynamic Cr	Static Cor	Grease	Oil
73.025	112.713	25.400	25.400	19.050	3.6	3.2	29685	29620	97000	155000	2700	3800
	117.475	30.163	30.163	23.813	3.6	3.2	33287	33462	118000	179000	2700	3700
	125.412	25.400	25.400	19.845	3.5	1.5	27680	27620	102000	164000	2700	3600
	127.000	30.162	31.000	22.225	3.5	3.3	42683	42620	131000	181000	2800	3700
	127.000	36.513	36.170	28.575	3.6	3.2	567	563	156000	226000	2500	3500
	149.225	53.975	54.229	44.450	3.5	3.3	6460	6420	284000	410000	2500	3400
	149.225	53.975	54.229	44.450	7.0	3.2	6460YA	6420	285000	404000	2200	3100
73.817	150.089	44.450	46.673	36.512	3.5	3.3	744	742	252000	345000	2400	3200
	112.712	25.400	25.400	19.050	1.5	3.3	29688	29620	86000	133000	3100	4100
	139.992	36.512	36.098	28.575	3.5	3.3	577	572	171000	252000	2500	3400
	125.412	25.400	25.400	19.845	3.5	1.5	27684	57620	102000	164000	2700	3600
	133.350	30.162	29.769	22.225	6.4	3.3	495AX	492A	118000	175000	2600	3500
	135.733	44.450	49.101	34.925	3.5	3.3	5760	5735	207000	295000	2600	3600
	136.525	30.162	29.769	22.225	3.5	3.3	495A	493	118000	175000	2600	3500
76.200	139.992	36.512	36.098	28.575	3.5	3.3	575	572	171000	252000	2500	3400
	161.925	47.625	48.260	38.100	3.5	3.3	755	752	273000	390000	2300	3100
	161.926	49.212	46.038	31.750	3.5	3.3	9285	9220	230000	263000	2100	3000
	168.275	53.975	56.363	41.275	6.4	3.3	843	832	340000	460000	2200	3000
	171.450	49.212	46.038	31.750	3.5	3.3	9380	9321	229000	271000	2000	2700
	190.500	57.150	57.531	46.038	3.5	3.3	HH221430	HH221410	425000	585000	1900	2600
	133.350	30.162	29.769	22.225	3.5	3.3	495AS	492A	118000	175000	2600	3500
77.788	135.733	44.450	46.101	34.925	3.5	3.3	5795	5735	215000	340000	2600	3600
	146.050	41.275	41.275	31.750	3.5	3.3	661	653	188000	260000	2500	3300
	150.089	44.450	46.675	36.512	3.5	3.3	750	742	273000	390000	2400	3200
	161.925	47.625	48.260	38.100	8.0	3.3	756A	752	273000	390000	2300	3100
	130.000	35.000	34.000	28.500	3.0	2.5	JM515649	JM515610	168000	256000	2400	3300
	133.350	30.162	29.769	22.225	3.5	3.3	496	492A	118000	175000	2600	3500
	133.350	33.338	33.338	26.195	3.5	0.8	47681	47620A	151000	228000	2600	3500
80.962	150.089	44.450	46.676	36.512	5.0	3.3	740	742	253000	345000	2400	3200
	168.275	53.975	56.363	41.275	0.8	3.3	838	832	340000	470000	2200	3000
	125.413	25.400	25.400	19.845	3.6	1.6	27687	27620	101000	162000	2400	3400
	133.350	30.162	29.769	22.225	3.5	3.3	495	492A	118000	175000	2600	3500
	133.350	33.338	33.338	26.195	3.5	0.8	47686	47620A	151000	228000	2600	3500
	133.350	33.338	33.338	26.195	3.6	3.2	47686	47620	145000	226000	2300	3200
	133.350	33.338	33.338	26.195	6.7	3.2	47687	47620	145000	226000	2300	3200
82.550	133.350	39.688	39.688	32.545	3.5	3.3	HM516449	HM546410	184000	320000	2600	3500
	139.992	36.512	36.098	28.575	3.5	3.3	580	572	171000	255000	2500	3400
	139.992	36.513	36.098	58.575	3.6	3.2	580R	572	175000	262000	2300	3200
	146.050	41.275	41.275	31.750	3.5	3.3	663	653	18000	260000	2500	3300
	161.925	47.625	48.260	38.100	3.5	3.3	757	752	273000	390000	2300	3100
	161.925	53.975	55.100	42.862	3.5	3.3	6559	6535	305000	460000	2300	3000
	168.275	53.975	56.363	41.275	3.5	3.3	842	832	340000	470000	2200	3000
84.138	133.350	30.162	29.769	22.225	3.5	3.3	498	492A	118000	175000	2600	3500
	171.450	49.212	46.038	31.750	3.5	3.3	9385	9321	229000	282000	2000	2700

Note : when load center is (-), and it is out of inner ring plane

Abutment and Fillet Dimensions (mm)						Eff. Load Centers (mm) a	Weight (kg)	
d <sub>a</sub> (min)	d <sub>b</sub> (min)	D <sub>a</sub> (max)	D <sub>b</sub> (max)	r <sub>1a</sub> (max)	r <sub>2a</sub> (max)		Cone	Cup
86.0	80.0	101.0	109.0	3.6	3.2	-0.8	0.593	0.278
87.0	80.0	104.0	112.0	3.6	3.2	2.4	0.744	0.446
88.0	82.0	115.0	120.0	3.5	1.5	-0.6	0.90	0.410
88.0	81.0	114.0	121.0	3.5	3.3	2.8	1.05	0.510
88.0	81.0	112.0	120.0	3.6	3.2	7.9	1.13	0.661
93.0	87.0	129.0	140.0	3.5	3.3	15.1	2.79	1.65
111.0	88.0	129.0	141.0	7.0	3.2	14.7	2.73	1.64
91.0	85.0	134.0	142.0	3.5	3.3	12.0	2.50	1.06
83.0	81.0	101.0	109.0	1.5	3.3	-0.9	0.575	0.290
91.0	85.0	125.0	133.0	3.5	3.3	5.3	1.65	0.820
91.0	84.0	115.0	120.0	3.5	1.5	0.6	0.83	0.410
98.0	86.0	120.0	128.0	6.4	3.3	0.8	1.20	0.430
94.0	88.0	119.0	130.0	3.5	3.3	11.7	1.83	0.882
92.0	86.0	122.0	130.0	3.5	3.3	0.8	1.26	0.490
92.0	86.0	125.0	133.0	3.5	3.3	5.3	1.50	0.810
95.0	88.0	147.0	150.0	3.5	3.3	11.9	3.50	1.60
103.0	90.4	138.0	153.0	3.5	3.3	0	2.90	1.40
101.0	89.0	149.0	155.0	6.4	3.3	18.4	4.10	1.73
105.0	98.2	147.0	164.0	3.5	3.3	-4.4	3.50	1.50
101.0	95.0	171.0	179.0	3.5	3.3	14.4	5.80	2.90
93.0	87.0	120.0	128.0	3.5	3.3	0.8	1.10	0.430
96.0	89.0	119.0	130.0	3.5	3.3	11.7	1.75	0.880
96.0	90.0	131.0	139.0	3.5	3.3	7.9	2.00	0.890
96.0	90.0	134.0	142.0	3.5	3.3	11.9	1.45	1.06
106.0	91.0	144.0	150.0	8.0	3.3	14.9	3.02	1.60
94.0	88.0	117.0	125.0	3.0	2.5	5.4	1.19	0.585
95.0	89.0	120.0	128.0	3.5	3.3	0.7	1.05	0.430
95.0	89.0	121.0	128.0	3.5	0.8	4.3	1.18	0.59
101.0	91.0	134.0	142.0	5.0	3.3	11.9	2.33	1.06
90.0	89.0	149.0	155.0	0.8	3.3	18.4	4.05	1.73
96.0	89.0	115.0	120.0	3.6	1.6	0.7	0.711	0.349
97.0	90.0	120.0	128.0	3.5	3.3	0.7	1.02	0.51
97.0	90.0	121.0	128.0	3.5	0.8	3.8	1.15	0.575
108.0	94.0	119.0	128.0	3.6	3.2	4.2	1.11	0.582
107.0	94.0	119.0	128.0	6.7	3.2	4.2	1.10	0.582
99.0	92.0	118.0	128.0	3.5	3.3	7.5	1.50	0.750
98.0	81.0	125.0	133.0	3.5	3.3	5.3	1.35	0.810
98.0	91.0	125.0	133.0	3.6	3.2	5.5	1.35	0.841
99.0	92.0	131.0	139.0	3.5	3.3	8.0	1.85	0.890
100.0	94.0	144.0	150.0	3.5	3.3	12.1	2.95	1.60
107.0	98.0	141.0	154.0	3.5	3.3	12.8	3.40	1.65
101.0	94.0	149.0	155.0	3.5	3.3	18.4	3.65	1.78
98.0	91.0	120.0	128.0	3.5	3.3	0.7	1.00	0.430
111.0	98.2	147.0	164.0	3.5	3.3	-4.4	3.20	1.50

d: 85.027 ~ 95.250 mm

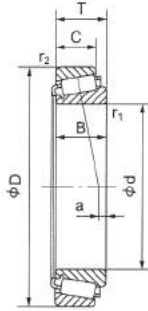

Principal Dimensions (mm)							Bearing Designations		Basic Load Ratings (N)		Limiting Speed (rpm)	
d	D	T	B	C	r <sub>1</sub> (min)	r <sub>2</sub> (min)	Cone	Cup	Dynamic Cr	Static Cor	Grease	Oil
85.027	150.089	44.450	46.672	36.512	3.5	3.3	749	742	253000	345000	2400	3200
	133.350	30.163	29.769	22.225	3.6	3.2	497	492A	133000	198000	2300	3200
	136.525	30.163	29.769	22.225	3.6	3.2	497	493	133000	198000	2300	3200
	142.138	42.862	42.862	34.133	4.8	3.3	HM617049	HM617010	210000	345000	2500	3300
85.725	152.400	39.688	36.322	30.163	3.6	3.2	596	592A	183000	287000	2100	2900
	161.925	47.625	48.260	38.100	3.5	3.3	458	752	273000	390000	2300	3100
	168.275	41.275	41.275	30.162	3.5	3.3	677	672	208000	310000	2000	2800
	168.275	53.975	56.363	41.275	3.5	3.3	841	832	340000	470000	2200	3000
87.312	190.500	57.150	57.531	44.450	8.0	3.3	869	854	365000	525000	1900	2600
	121.442	15.083	15.083	11.112	1.5	1.5	LL217849	LL217810	77500	132000	2700	3500
	147.638	35.717	16.322	26.192	3.5	0.8	593	592XE	185000	288000	2300	3100
	149.225	31.750	28.971	27.608	3.0	3.3	42350	42587	139000	214000	2300	3100
	152.400	39.688	36.322	30.163	3.6	3.2	593	592A	183000	287000	2100	2900
	152.400	39.688	39.688	30.163	6.4	3.2	HM518445	HM518410	548000	359000	2100	2900
	161.925	53.975	55.100	42.862	3.5	3.3	6580	6535	305000	460000	2200	3000
	161.925	53.974	55.100	42.863	3.6	3.2	6580R	6535	316000	471000	2000	2800
88.900	168.275	41.275	41.275	30.162	3.5	3.3	679	572	208000	310000	2000	2800
	168.275	53.975	56.363	41.275	3.5	3.3	850	832	340000	470000	2200	3000
	168.275	53.975	56.363	41.275	3.6	3.2	850R	832	344000	467000	2000	2800
	171.450	47.625	48.260	38.100	5.0	3.3	77350	77675	239000	340000	2100	2800
	190.500	57.150	57.531	44.450	8.0	3.3	855	854	340000	525000	19000	2600
	200.000	52.761	49.212	34.925	3.5	3.3	98350	98788	289000	365000	2000	2700
89.974	146.975	40.000	40.000	32.499	7.1	3.6	HM218248	HM218210	306000	310000	2100	3000
90.488	161.925	47.625	48.260	38.100	3.6	3.2	760	752	273000	391000	2000	2900
	146.050	33.338	34.925	26.195	3.5	3.3	47890	47820	157000	250000	2300	3100
	147.638	35.717	36.322	26.192	3.5	0.8	598	592XE	185000	288000	2300	3100
	148.430	28.575	28.971	21.433	3.5	3.0	42362	42584	139000	214000	2300	3100
	150.000	35.992	36.322	27.000	6.4	3.0	598A	593X	183000	287000	2100	2900
92.075	152.400	39.688	36.322	30.162	6.4	3.3	598A	592A	185000	288000	2300	2100
	152.400	39.688	36.322	30.163	6.4	3.2	598AUR	592AUR	183000	287000	2100	2900
	168.275	41.275	41.275	30.162	6.4	3.3	681A	672	208000	310000	2000	2800
	180.975	47.625	48.006	38.100	3.5	3.3	778	772	278000	415000	2000	2700
	190.500	57.150	57.531	44.450	8.0	3.3	857	854	340000	525000	1900	2600
93.662	148.430	28.575	28.971	21.433	3.0	3.0	42368	42584	139000	214000	2300	3100
	146.050	33.338	34.925	26.195	3.5	3.3	47896	47820	157000	250000	2300	3100
	147.635	35.717	36.322	26.195	3.5	0.8	594	592XS	185000	288000	2300	3100
	150.000	35.992	36.322	27.000	3.6	3.0	594	593X	183000	287000	2100	2900
	152.400	39.688	36.322	30.163	3.6	3.2	594	592A	183000	287000	2100	2900
95.250	157.162	36.512	36.116	26.195	3.5	3.3	52375	52618	176000	277000	2100	2900
	168.275	41.275	41.275	30.162	3.5	3.3	683	672	208000	310000	2000	2800
	171.450	47.625	48.260	38.100	3.5	3.3	77375	77675	239000	340000	2100	2800
	190.500	57.150	57.531	44.450	8.0	3.3	864	854	365000	525000	1900	2600

Note : when load center is (-), and it is out of inner ring plane

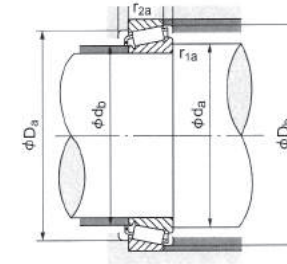

Abutment and Fillet Dimensions (mm)							Eff. Load Centers (mm) a	Weight (kg)	
d <sub>a</sub> (min)	d <sub>b</sub> (min)	D <sub>a</sub> (max)	D <sub>b</sub> (max)	r <sub>1a</sub> (max)	r <sub>2a</sub> (max)			Cone	Cup
101.0	95.0	134.0	142.0	3.5	3.3	11.9		2.15	1.05
99.0	93.0	120.0	128.0	3.6	3.2	0.3		0.969	0.441
99.0	93.0	122.0	130.0	3.6	3.2	0.3		0.972	0.558
106.0	93.0	125.0	137.0	4.8	3.3	7.4		1.80	0.910
102.0	96.0	135.0	144.0	3.6	3.2	2.6		1.81	1.06
103.0	97.0	144.0	150.0	3.5	3.3	11.9		2.65	1.60
105.0	99.0	149.0	160.0	3.5	3.3	2.8		2.87	1.27
101.0	94.0	149.0	155.0	3.5	3.3	18.4		3.53	1.78
120.0	105.0	171.0	179.0	8.0	3.3	15.0		5.67	2.69
97.0	94.0	116.0	119.0	1.5	1.5	-0.1		0.490	0.245
104.0	98.0	135.0	142.0	3.5	0.8	-1.4		1.70	1.05
104.0	98.0	134.0	143.0	3.0	3.3	3.1		1.32	0.590
121.0	105.0	135.0	144.0	3.6	3.2	2.6		1.69	1.06
110.0	98.0	135.0	114.0	4.6	3.2	6.6		2.09	0.786
109.0	101.9	141.0	154.0	3.5	3.3	13.1		3.10	1.65
109.0	98.0	141.0	154.0	3.6	3.2	12.9		3.06	1.68
105.0	99.0	149.0	160.0	3.5	3.3	2.8		2.89	1.27
106.0	100.0	149.0	155.0	3.5	3.3	18.4		3.31	1.78
122.0	103.0	149.0	155.0	3.6	3.2	19.0		3.26	1.75
110.0	101.0	153.0	161.0	5.0	3.3	9.6		3.30	1.57
118.0	103.0	170.0	174.0	8.0	3.3	15.4		5.05	2.69
105.0	98.0	170.0	193.0	3.5	3.3	1.8		4.80	2.55
112.0	99.0	133.0	141.0	7.1	3.6	9.2		1.64	0.799
107.0	101.0	144.0	150.0	3.6	3.2	12.1		2.10	1.62
107.0	101.0	131.0	140.0	3.5	3.3	1.0		1.63	0.660
107.0	101.0	135.0	144.0	3.5	0.8	-1.5		1.65	1.05
107.0	101.0	134.0	142.0	3.5	3.0	-3.1		1.30	0.550
121.0	105.0	126.0	143.0	6.4	3.0	2.6		1.55	0.780
113.0	101.0	135.0	144.0	6.4	3.3	2.5		1.67	1.15
121.0	105.0	135.0	144.0	6.4	3.2	2.6		1.57	1.06
116.0	104.0	149.0	160.0	6.4	3.3	2.8		2.64	1.27
114.0	107.0	161.0	168.0	3.5	3.3	8.1		3.49	1.94
121.0	106.0	170.0	174.0	8.0	3.3	15.4		4.83	2.69
107.0	102.0	134.0	142.0	3.0	3.0	-3.1		1.28	0.550
110.0	103.0	131.0	140.0	3.5	3.3	1.0		1.53	0.660
110.0	104.0	135.0	142.0	3.5	0.8	-1.5		2.10	1.05
121.0	105.0	126.0	143.0	3.6	3.0	2.6		1.43	0.780
121.0	105.0	135.0	144.0	3.6	3.2	2.6		1.43	1.06
112.0	105.0	142.0	152.0	3.5	3.3	-2.0		1.90	0.700
113.0	106.0	149.0	160.0	3.5	3.3	2.8		2.42	1.27
110.0	101.0	153.0	161.0	3.5	3.3	9.6		3.23	1.57
123.0	108.0	170.0	174.0	8.0	3.3	9.4		4.60	2.69



d: 98.425 ~ 127.000 mm

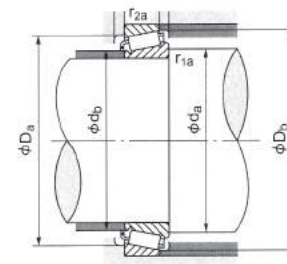
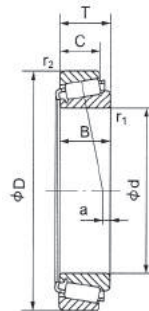

Principal Dimensions (mm)							Bearing Designations		Basic Load Ratings (N)		Limiting Speed (rpm)			Abutment and Fillet Dimensions (mm)						Eff. Load Centers (mm) a		Weight (kg)	
d	D	T	B	C	r1 (min)	r2 (min)	Cone	Cup	Dynamic Cr	Static Cor	Grease	Oil		da (min)	db (min)	Da (max)	Db (max)	r1a (max)	r2a (max)			Cone	Cup
98.425	161.925	39.688	36.116	29.370	3.5	3.3	52387	52638	176000	277000	2100	2900		117.0	111.0	142.0	152.0	3.5	3.3	3.6		1.95	0.900
	168.275	41.275	41.275	30.162	3.5	3.3	685	672	208000	310000	2000	2800		116.0	109.0	149.0	160.0	3.5	3.3	2.8		2.35	1.27
	180.975	47.625	48.006	38.162	3.5	3.3	779	772	278000	415000	2000	2700		116.0	110.0	161.0	168.0	3.5	3.3	8.1		3.30	1.94
	190.500	57.150	57.531	44.450	3.5	3.3	866	854	365000	525000	1900	2600		118.0	111.0	170.0	174.0	3.5	3.3	15.4		4.45	2.69
	180.975	47.625	48.006	38.100	3.5	3.3	783	772	278000	415000	2000	2700		122.0	116.0	161.0	168.0	3.5	3.3	8.1		3.22	1.94
100.000	157.162	36.512	36.116	26.195	3.5	3.3	52393	52618	176000	277000	2100	2900		116.0	109.0	142.0	152.0	3.5	3.3	0.4		1.79	0.700
101.600	157.162	36.512	36.116	26.195	3.5	3.3	52400	52618	176000	277000	2100	2900		117.0	111.0	142.0	152.0	3.5	3.3	0.4		1.70	0.700
	168.275	41.275	41.275	30.162	3.5	3.3	687	672	208000	31000	2000	2800		118.0	112.0	149.0	160.0	3.5	3.3	2.8		2.13	1.27
	180.975	47.625	48.006	38.100	3.5	3.3	780	772	278000	415000	2000	2700		119.0	113.0	161.0	168.0	3.5	3.3	8.1		3.04	1.94
	190.500	57.150	57.531	44.450	8.0	3.3	864	854	365000	525000	1900	2600		129.0	114.0	170.0	174.0	8.0	3.3	15.4		4.15	2.69
	190.500	57.150	57.531	46.038	8.0	3.3	HH221449	HH221410	425000	585000	1900	2600		131.0	115.0	171.0	179.0	8.0	3.3	15.0		4.70	2.28
	200.000	52.761	49.212	34.925	3.5	3.3	98400	98788	289000	365000	2000	2700		105.0	110.0	170.0	193.0	3.5	3.3	1.8		1.55	2.55
	212.725	66.675	66.675	53.975	7.0	3.3	941	932	455000	665000	1700	2400		141.0	128.0	187.0	193.0	7.0	3.3	19.7		6.05	4.06
	212.725	66.675	66.675	53.975	7.0	3.3	HH224335	HH224310	480000	670000	1700	2300		132.0	121.0	192.0	201.0	7.0	3.3	18.9		8.30	3.02
104.775	180.975	47.625	48.006	38.100	3.5	3.3	782	772	278000	415000	2000	2700		122.0	116.0	161.0	168.0	3.5	3.3	8.1		2.90	1.94
	190.500	47.625	49.212	34.925	3.5	3.3	71412	71750	273000	425000	1800	2500		124.0	118.0	171.0	181.0	3.5	3.3	6.5		4.09	1.74
	146.050	21.433	21.433	16.670	1.5	1.5	L521949	L521910	935000	155000	2200	3000		116.0	114.0	136.0	141.0	1.5	1.5	-4.5		0.640	0.325
107.950	158.750	23.020	21.438	15.875	3.6	3.2	37425	37625	104000	169000	1900	2700		122.0	115.0	143.0	152.0	3.6	3.2	-13.5		0.882	0.498
	159.987	34.925	34.925	26.988	3.5	3.3	LM522546	LM522510	176000	277000	2000	2800		122.0	116.0	146.0	154.0	3.5	3.3	1.4		1.55	0.775
	161.925	34.925	34.925	26.988	3.5	3.3	48190	48120	164000	280000	2100	2800		122.0	116.0	146.0	156.0	3.5	3.3	-3.9		1.60	0.830
	165.100	36.512	36.512	26.988	3.5	3.3	56425	56650	190000	305000	2000	2800		123.0	117.0	149.0	159.0	3.5	3.3	-2.0		1.75	0.850
	190.500	47.625	49.212	34.925	3.5	3.3	71425	71750	273000	425000	1800	2500		126.0	120.0	171.0	181.0	3.5	3.3	6.5		3.88	1.74
	212.725	66.675	66.675	53.975	8.0	3.3	936	932	455000	665000	1700	2400		141.0	128.0	187.0	193.0	8.0	3.3	19.7		5.86	4.06
	212.725	66.675	66.675	53.975	8.0	3.3	HH224340	HH224310	480000	670000	1700	2300		139.0	126.0	192.0	201.7	8.0	3.3	18.9		7.74	3.02
	177.800	41.275	41.275	30.162	3.5	3.3	66450	64700	231000	370000	1900	2600		131.0	125.0	160.0	172.0	3.5	3.3	-1.2		2.46	1.15
114.300	181.000	34.925	31.750	25.400	3.5	3.3	68450	68712	173000	249000	1900	2500		136.0	125.0	160.0	172.0	3.5	3.3	-5.5		1.87	1.10
	190.500	47.625	49.212	34.925	3.5	3.3	71450	71750	273000	425000	1800	2500		132.0	125.0	171.0	181.0	3.5	3.3	6.5		3.48	1.74
	212.725	66.675	66.675	53.975	7.0	3.3	938	932	455000	665000	1700	2400		141.0	128.0	187.0	193.1	7.0	3.3	19.7		5.73	4.06
	212.725	66.674	66.675	53.975	7.0	3.3	HH224346	HH224310	480000	670000	1700	2300		143.0	131.0	192.0	201.7	7.0	3.3	18.7		7.31	3.02
115.087	190.500	47.625	49.212	34.925	3.5	3.3	71453	71750	273000	425000	1800	2500		133.0	126.0	171.0	181.0	3.5	3.3	6.5		3.43	1.74
120.650	169.862	25.400	26.192	20.638	1.5	1.5	L225842	L225810	128000	264000	1500	2000		140.0	137.0	157.0	165.0	1.5	1.5	0.4		1.48	0.505
	174.625	35.720	36.512	27.783	3.5	1.5	M224749	M224710	212000	385000	1900	2600		135.0	129.0	103.0	168.0	3.6	1.5	3.6		1.82	0.835
	206.375	47.625	47.625	34.925	3.3	3.3	795	792	299000	500000	1600	2200		139.0	134.0	186.0	198.0	3.3	3.3	2.1		4.52	1.92
	234.950	63.500	63.500	49.212	6.4	3.3	95475	95925	500000	770000	1500	2000		152.0	140.0	209.0	217.0	6.4	3.3	14.0		8.17	3.96
	165.895	18.258	17.462	13.495	1.5	1.5	LL225749	LL225710	71500	125000	1500	2000		140.0	137.0	159.0	162.0	1.5	1.5	-6.1		0.678	0.270
127.000	180.975	25.400	26.195	20.638	1.5	1.5	L225849	L225818	128000	264000	1500	2000		140.0	137.0	157.0	165.0	1.5	1.5	0.4		1.42	1.01
	182.562	39.688	38.100	33.338	3.5	3.3	48290	48220	235000	445000	1800	2400		141.0	135.0	168.0	176.0	3.5	3.3	5.6		2.14	1.15
	196.850	46.038	46.038	38.100	3.5	3.3	67388	67322	295000	520000	1700	2300		144.0	138.0	180.0	189.0	3.5	3.3	6.4		3.62	1.44
	215.900	47.625	47.625	34.925	3.5	3.3	74500	74850	320000	565000	1500	2100		148.0	141.0	196.0	208.0	3.5	3.3	-2.2		5.01	1.93
	228.600	53.975	49.428	38.100	3.5	3.3	HM926747	HM926710	350000	500000	1500	2000		167.0	143.0	187.0	224.0	3.5	3.3	-14.4		5.85	2.94
	234.950	63.500	63.500	49.212	6.4	3.3	95500	95925	500000	770000	1500	2000		154.0	142.0	209.0	217.0	6.4	3.3	12.0		8.02	3.96

Note : when load center is (-), and it is out of inner ring plane

d: 128.588 ~ 187.325 mm

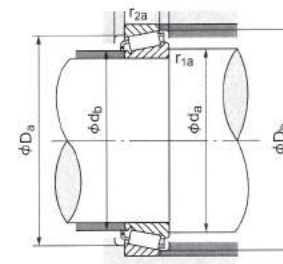
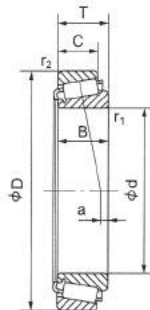

Principal Dimensions (mm)								Bearing Designations		Basic Load Ratings (N)		Limiting Speed (rpm)			Abutment and Fillet Dimensions (mm)						Eff. Load Centers (mm) a	Weight (kg)	
d	D	T	B	C	r1 (min)	r2 (min)		Cone	Cup	Dynamic Cr	Static Cor	Grease	Oil		da (min)	db (min)	Da (max)	Db (max)	r1a (max)	r2a (max)		Cone	Cup
128.588	190.500	34.925	31.750	25.400	3.5	3.3		<b>48506</b>	<b>48750</b>	222000	410000	1600	2100		151.0	136.0	166.0	184.0	3.5	3.3	-15.4	2.12	1.16
	206.375	47.625	47.625	34.925	3.3	3.3		<b>799</b>	<b>792</b>	299000	500000	1700	2200		146.0	140.0	186.0	198.0	3.3	3.3	2.1	3.84	1.92
133.350	190.500	39.688	39.688	33.338	3.5	3.3		<b>48385</b>	<b>48320</b>	219000	430000	1700	2300		148.0	142.0	177.0	184.0	3.3	3.3	4.0	2.41	1.15
	203.200	46.038	46.038	38.100	3.5	3.3		<b>67390</b>	<b>67324</b>	295000	520000	1700	2200		149.0	143.0	183.0	193.0	3.5	3.3	6.4	3.40	1.61
136.350	234.950	63.500	63.500	49.212	9.7	3.3		<b>95525</b>	<b>95925</b>	500000	770000	1500	2000		166.0	148.0	209.0	217.0	9.7	3.3	14.0	8.00	3.96
	190.500	39.688	39.688	33.338	3.5	3.3		<b>48393</b>	<b>48320</b>	219000	430000	1700	2300		151.0	144.0	177.0	184.0	3.5	3.3	4.0	2.21	1.15
139.700	215.900	47.625	47.625	34.925	3.5	3.3		<b>74537</b>	<b>74820</b>	320000	565000	1500	2100		148.0	141.0	196.0	208.0	3.5	3.3	-2.2	5.12	1.93
	224.600	57.150	57.150	44.450	3.5	3.3		<b>896</b>	<b>892</b>	410000	655000	1600	2100		173.0	156.0	200.0	222.0	3.5	3.3	7.6	6.18	2.76
142.875	180.975	21.433	50.638	16.670	1.5	1.5		<b>LL428349</b>	<b>LL428310</b>	120000	214000	1700	2200		150.0	145.0	175.0	175.0	1.5	1.5	-7.3	0.90	0.45
	215.900	47.625	47.625	34.925	3.5	3.3		<b>74550</b>	<b>74850</b>	320000	565000	1500	2100		158.0	151.0	196.0	208.0	3.5	3.3	-2.2	4.12	1.93
146.050	228.600	57.150	57.150	44.450	3.5	3.3		<b>898</b>	<b>892</b>	410000	655000	1600	2100		173.0	156.0	200.0	222.0	3.5	3.3	7.6	6.24	2.76
	241.300	57.150	56.642	44.450	3.5	3.3		<b>82550</b>	<b>82950</b>	410000	665000	1500	2100		179.0	161.0	205.0	230.0	3.5	3.3	3.6	6.34	3.70
149.225	254.000	66.675	66.675	47.625	7.0	3.3		<b>99550</b>	<b>99100</b>	525000	855000	1300	1800		170.0	156.0	227.0	238.0	7.0	3.3	12.2	9.87	4.28
	200.025	41.275	39.688	34.130	8.0	3.3		<b>48684</b>	<b>48620</b>	246000	505000	1600	2100		166.0	151.0	185.0	193.0	8.0	3.3	5.6	2.43	1.35
152.400	193.675	28.575	28.575	23.020	4.8	1.5		<b>36691</b>	<b>36620</b>	181000	375000	1600	2200		162.0	153.0	182.0	188.0	4.8	1.5	-4.9	1.62	0.77
	203.200	28.575	28.575	23.020	1.5	1.5		<b>36690</b>	<b>36626</b>	181000	375000	1600	2200		155.0	153.0	186.0	190.0	1.5	1.5	-4.9	1.85	0.95
154.150	241.300	57.150	56.642	44.450	3.5	3.3		<b>82576</b>	<b>82950</b>	410000	665000	1500	2100		179.0	161.0	205.0	230.0	3.5	3.3	3.6	6.34	3.70
	254.000	66.675	66.675	47.625	7.0	3.3		<b>99575</b>	<b>99100</b>	525000	855000	1300	1800		175.0	162.0	227.0	238.0	7.0	3.3	12.2	9.10	4.28
157.325	268.288	74.612	74.612	57.150	6.4	6.4		<b>EE107057</b>	<b>107105</b>	600000	925000	1300	1800		175.0	163.0	227.0	238.0	6.4	6.4	14.0	12.2	5.92
	304.800	88.900	82.550	57.150	6.4	6.4		<b>HH932145</b>	<b>HH932110</b>	730000	990000	1300	1800		208.0	172.0	245.0	293.0	6.4	6.4	-4.5	1.85	8.80
159.225	236.538	57.150	56.642	44.450	3.5	3.3		<b>HM231149</b>	<b>HM231110</b>	475000	760000	1200	1700		175.0	163.0	215.0	229.0	3.5	3.3	15.7	6.42	2.72
	254.000	66.675	66.675	47.625	7.0	3.3		<b>99587</b>	<b>99100</b>	525000	855000	1300	1800		178.0	165.0	227.0	238.0	7.0	3.3	12.2	8.73	4.28
161.325	268.288	74.612	74.612	57.150	6.4	6.4		<b>EE107060</b>	<b>107105</b>	600000	925000	1300	1800		181.0	162.0	237.0	238.0	6.4	6.4	14.0	11.6	5.92
	266.700	47.625	46.833	38.100	3.6	3.2		<b>67883</b>	<b>67820</b>	339000	703000	1100	1500		232.0	207.0	234.0	259.0	3.6	3.2	-10.2	6.05	2.58
163.325	266.700	47.625	46.833	38.100	3.6	3.2		<b>67884</b>	<b>67820</b>	339000	703000	1100	1500		232.0	207.0	234.0	259.0	3.6	3.2	-10.2	5.71	2.58

Note : when load center is (-), and it is out of inner ring plane